



GRAND POLO  
CLUB & RESORT



CHEVALIA  
FIELDS

EMAAR

Grand Polo Club & Resort





## Curated *Equestrian* *Lifestyle*

Grand Polo Club & Resort is a masterplan which is built to strike fine balance between lifestyle principles of leisure, nature, connectivity, wellness and recreation. Whilst having the equestrian prestige at its heart, the green spaces loop-around and branch-out across the masterplan, connecting the residences thereby fostering a sense of community and belonging.



# Effortlessly Connected

Grand Polo Club & Resort enjoys a prime location with swift access to Dubai's key destinations—offering the perfect balance between city vibrance and estate serenity.

05 mins to Al Maktoum Int'l Airport

10 mins to Expo City Dubai

05 mins to The Oasis

30 mins to Downtown Dubai

### DUBAI METRO LINES

- RED LINE
- GREEN LINE
- FUTURE BLUE LINE

*Verdant Vistas, Regal Living*



# A Vision *Reimagined*

Chevalia Fields is where equestrian heritage meets the future of luxury living. Inspired by the graceful spirit of the horse, this is a place where freedom, elegance, and nature exist in perfect harmony. Sweeping green landscapes unfold around modern architectural masterpieces—each designed to unite form with purpose, beauty with meaning.

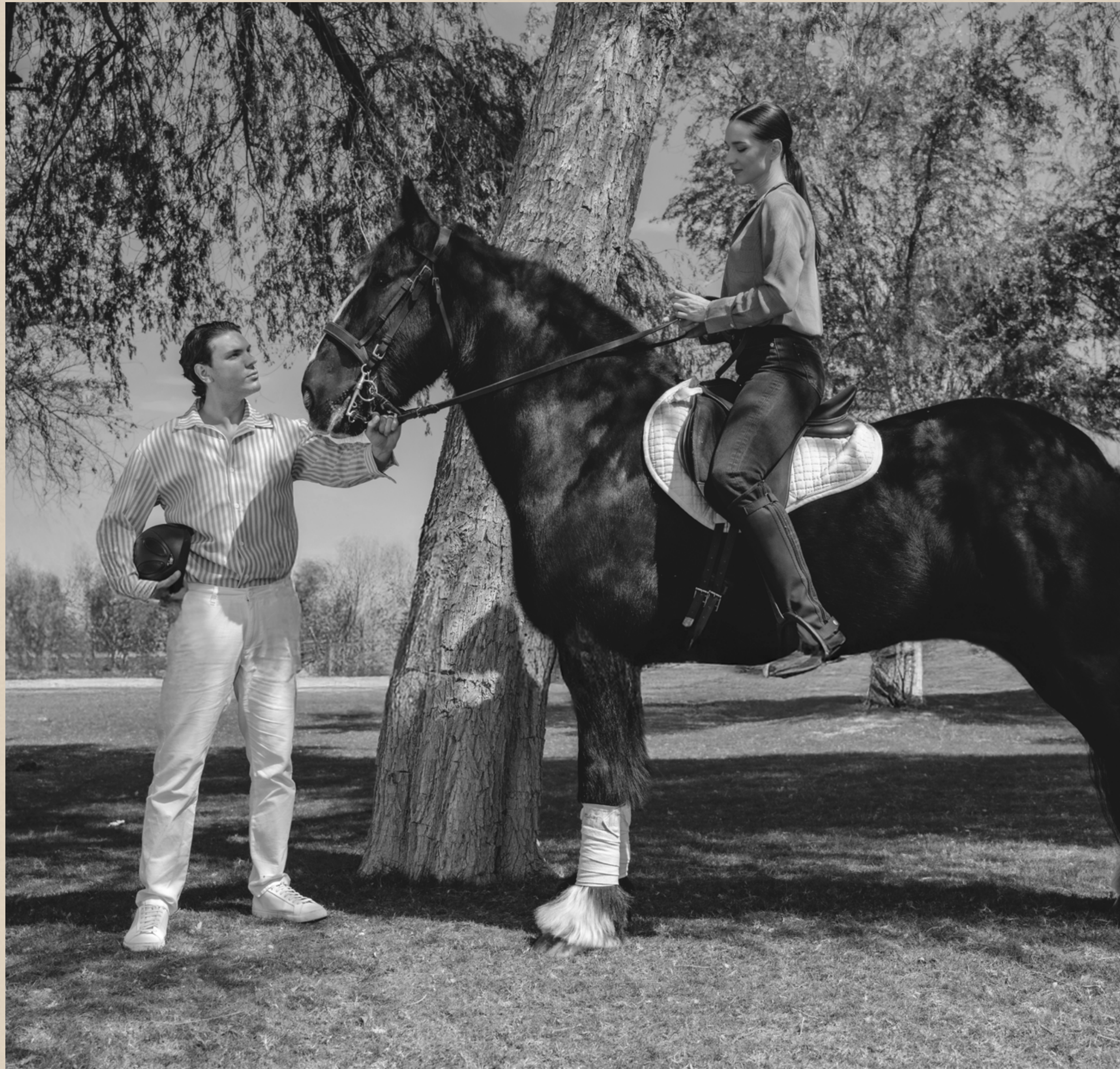



**CHEVALIA  
FIELDS**  
*Grand Polo Club & Resort*



**GRAND POLO**  
CLUB & RESORT

- 1 The Clubhouse
- 2 The Stables
- 3 The Polo Fields
- 4 Chevalia Estate
- 5 Chevalia Fields
- 6 Montura
- 7 Montura 2
- 8 Montura 3



**EMAAR**

Welcome to  
**CHEVALIA**  
FIELDS



# The Green Core

A living landmark at the centre of it all—The Green Core is home to three majestic polo fields, a luxury clubhouse, and private stables, - it's the soul of Chevalia Fields. It frames each day with sweeping green views, calm and a sense of prestige that lingers in every glance.



The Clubhouse



The Polo Fields



The Stables

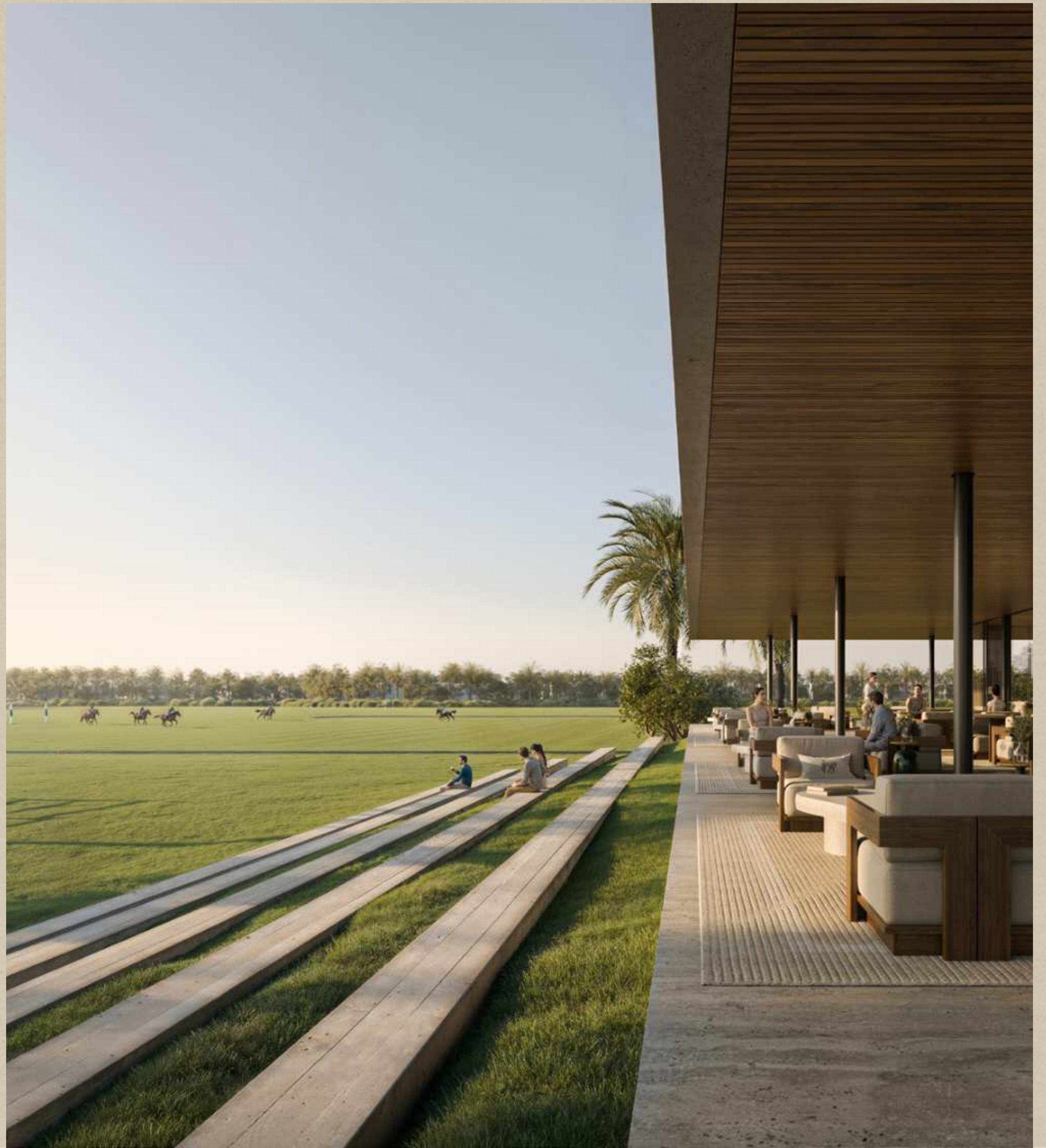



## The Clubhouse

Nestled in the centre of the equestrian haven and surrounded by elegant villas, the Clubhouse is a modern-day masterpiece. Its bold, linear form reflects the poise and power of Polo. A fusion of Arabian heritage and avant-garde architecture, it captivates while fosters connection.





THE CLUBHOUSE

*Where Luxury Meets Leisure*



# The Polo *Fields*

Set across 340,000 sqm, the Polo Fields are sculpted to echo the pulse of the sport. The grace of horzses, spirit of riders, and the elegance of equestrian heritage merge with contemporary landscape design. Grounded in earthy textures and timeless tradition, this is a terrain where legacy comes alive.

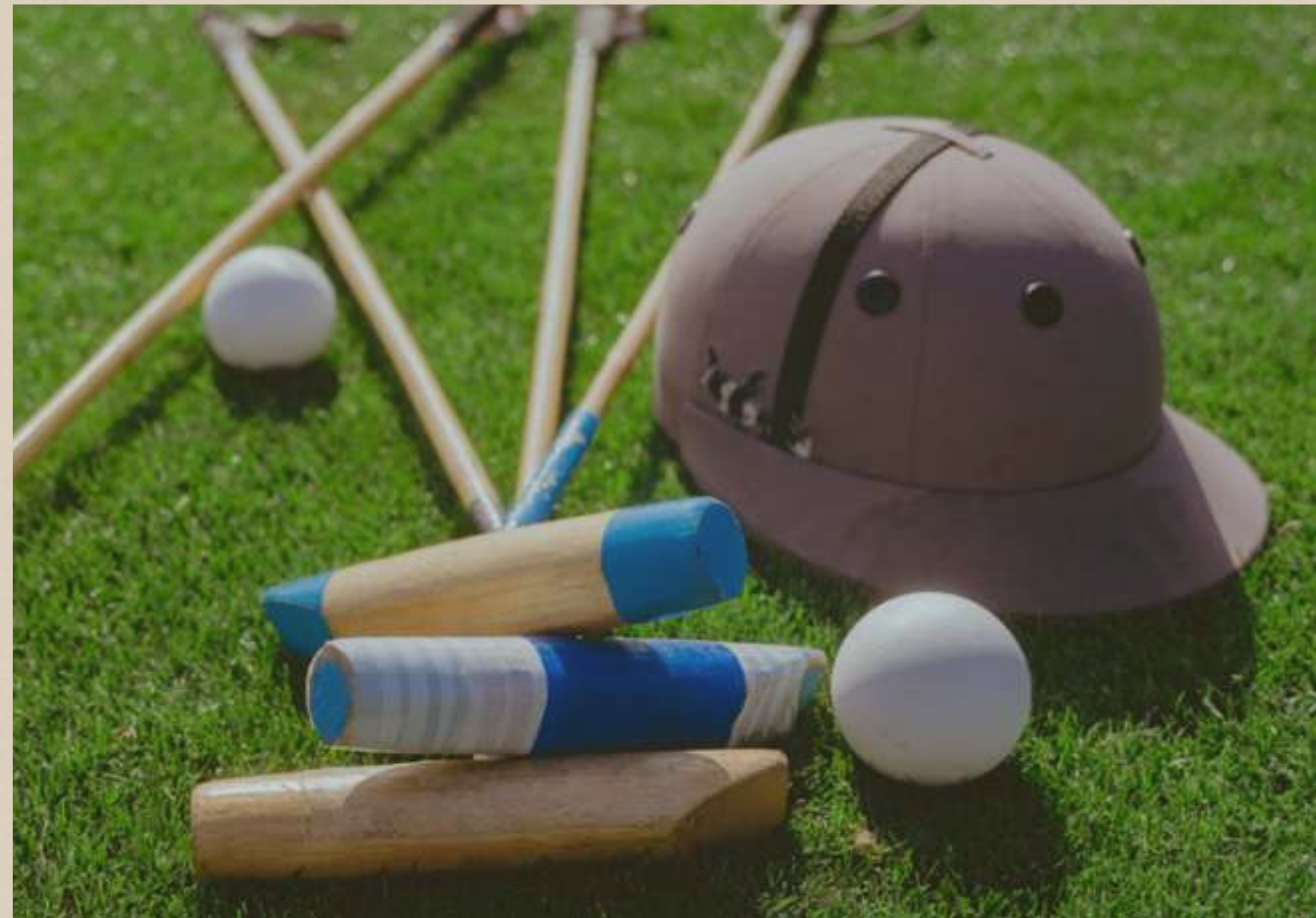

Vistas Crafted by *Nature*





## The *Stables*

Tucked gracefully within the estate, the Stables unfold in a sweeping circular form—an architectural ode to motion and majesty. At its centre, a vibrant courtyard welcomes nature's beauty, while flowing water features add rhythm and reflection to the scene. This sculptural sanctuary is a landmark of equestrian design—crafted to inspire, connect, and captivate.



Ode to Equine *Passion*





AMENITIES

## Realms of *Leisure*

Step into a world where recreation is reimagined. From the sculptural presence of the galloping fountain to the charm of the art pavilion, every space is designed to inspire moments of joy and connection. Whether it's a morning padel match, an afternoon in the mounded garden, or moonlit reflections beside open lawns—this is leisure, elevated to art.



Galloping Fountain



Fitness Area & Padel Courts



Art Pavilion Resting Areas



Petanque



Open Lawn



*Blue Horizon Over Galloping Greens*



CLUBHOUSE INFINITY POOL

RESIDENTIAL UNIT TYPES

# Essence of *Equestrian Living*



Homes of grandeur, where architecture embodies the elegance of equestrian form, and golden light illuminates meticulously curated landscapes. In this haven, each day unfolds not just with beauty, but with a profound sense of belonging.



## Homes that Harness *Spirit of Polo*

At the edge of the masterplan's verdant Green Core, Chevalia Fields unveils a collection of 4- & 5-bedroom villas, each a masterpiece of design inspired by equestrian grace and contemporary luxury. Set within emerald landscapes that evoke the spirit of polo, these homes invite to live within nature's embrace and breathtaking vistas.



INTERIORS

# Crafted for *Legacy*



Within these villas, elegance is realised in its truest form. Lustrous marble, expertly crafted wood, and refined textures evoke an air of sophisticated luxury. Light dances gracefully through each room, infusing the space with a fluid harmony. This is opulence that transcends time, enduring in both its design and panoramic views.







# Global *Lifestyle Developer*

A leader in the global real estate market, EMAAR has grown over the years to become the largest real estate developer outside of China. You will be investing with one of the best-regarded brands in the world\*.

AED 114 Bn  
Market Cap - FY 2024

AED 175 Bn  
Net Profit - FY 2024

AED 355 Bn\*  
Revenue

10+  
Global Market Presence

118,400+  
Residential Units  
Delivered Globally

50,500  
Residential Units Currently  
Under Development

\*As of FY 2024

# CHEVALIA FIELDS

*Grand Polo Club & Resort*

For more information please call 800 36227 (UAE) / +971 4 366 1688 (International)  
or talk to our Property Advisor directly at +971 4888 8844 from 9 AM to 7 PM (GST), Monday to Friday.  
Visit our online sales centre at [emaar.com](http://emaar.com) or any of our Sales Centres across the UAE.

## DUBAI

Emaar Sales Centre | Next to Souq Al Bahar, Downtown Dubai

9:30 AM to 10 PM, Sunday - Friday

9:30 AM to 7 PM, Saturday

Dubai Hills Estate Sales Pavilion | Umm Suqeim Road

Dubai Creek Harbour Sales Pavilion | Ras Al Khor

From 9:30 AM to 7 PM, Sunday - Saturday

## ABU DHABI

Emaar Sales Centre | Al Nahda Tower, Ground Floor,  
4th Street, Corniche, Al Muroor Road

From 9:30 AM to 7 PM, Sunday - Friday

# EMAAR